

BAKO VISION

BG Series

Clean and See Through Displaying,
 Innovative Transparent Technology

Excellent Viewing Angle
 Hidden Cable Appearance
 Easy to Install and Dismantle
 Extremely versatile and highly customizable

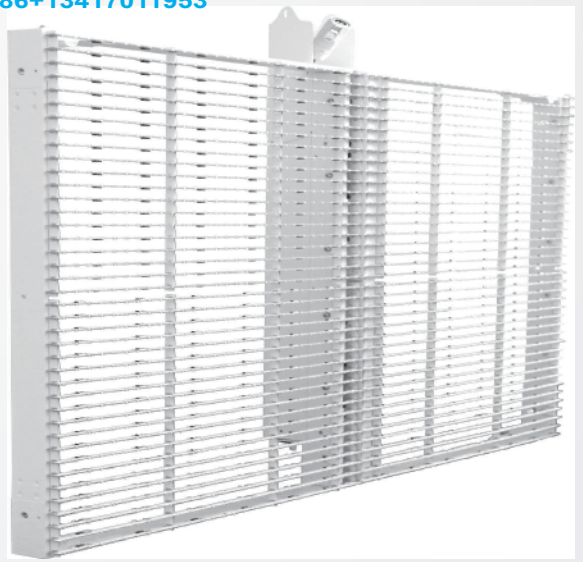

Slim, Light Weight and Quiet

- › 35mm-45mm thickness
- › 14kg per square meter
- › Available to attach onto glass wall directly

High Transparency and Concise

- › 60-80% transparency rate among different pitches
- › Variable brightness options for day and night environment
- › Hidden cable design looks clean and concise

Customizable and Versatile

- › Unlimited orientation, highly customizable
- › Suitable for any size and shape
- › Convex, concave, wave, cylindrical,
 fit any indoor architectural structures

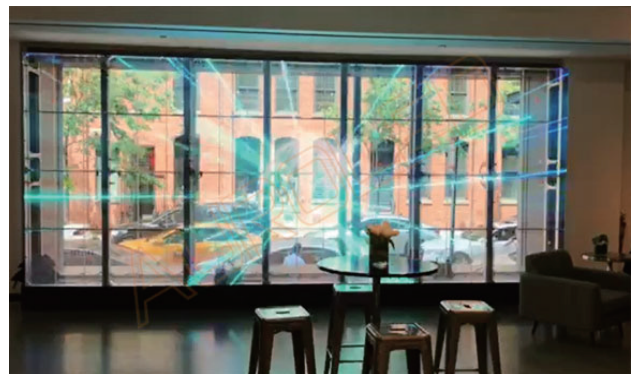

BG / Specifications

	BG-2.5-7.8	BG-3.9-7.8	BG-5-8	BG-10	BG-16
Physical Pitch	2.5 × 7.8 mm	3.9 × 7.8 mm	5 × 8 mm	10.4 × 10.4 mm	16 × 16 mm
Pixel Configuration	SMD 1921	SMD 1921	SMD 1921	SMD 1921	SMD 1921
Pixel Density	50,688 pixels/m ²	32,256 pixels/m ²	25,000pixels/m ²	9,216 pixels/m ²	3,906 pixels/m ²
Module Dimensions (W × H) (mm)	500 × 125	500 × 125	480 × 320	500 × 125	480 × 320
Panel Dimensions (mm)	1000 × 500	1000 × 500	960 × 640	1000× 500	960 × 640
NO.of Modules Per Panel (W × H)	2 × 4	2 × 4	2 × 2	2 × 4	2 × 2
Physical Resolution of Module (W × H)	200 × 16	128 × 16	96 × 40	48 × 12	30 × 20
Physical Resolution of Panel (W × H)	400 × 64	256 × 64	192 × 80	96 × 48	60 × 40
Panel Material	Aluminum	Aluminum	Aluminum	Aluminum	Aluminum
Weight	<14 kg/m ²	<14 kg/m ²	<14 kg/m ²	<14 kg/m ²	<14 kg/m ²
Gray Scale	16 bit	16 bit	16 bit	16 bit	16 bit
Colours	281 trillion	281 trillion	281 trillion	281 trillion	281 trillion
Contrast Ratio	2,000 : 1	2,000 : 1	2,000 : 1	2,000 : 1	2,000 : 1
Average Power Consumption	240 W/m ²	180 W/m ²	203 W/m ²	140 W/m ²	218 W/m ²
Max Power Consumption	700 W/m ²	560 W/m ²	670 W/m ²	400 W/m ²	650 W/m ²
Operating Temp/Humidity	-10 C - 60 C / 10% - 60%	-10 C - 60 C / 10% - 60%	-10 C - 60 C / 10% - 60%	-10 C - 60 C / 10% - 60%	-10 C - 60 C / 10% - 60%
Storage Temp/Humidity	-30 C - 60 C / 10% - 60%	-30 C - 60 C / 10% - 60%	-30 C - 60 C / 10% - 60%	-30 C - 60 C / 10% - 60%	-30 C - 60 C / 10% - 60%
Refresh Rate	>1,920 Hz	>1,920 Hz	>1,920 Hz	>1,920 Hz	>1,920 Hz
Brightness	1,000~4,200 nits	1,000~4,200 nits	>5,500 nits	1,000~4,200 nits	>5,500nits
Horizontal Viewing Angle	160°	160°	160°	160°	160°
Vertical Viewing Angle	140°	140°	140°	140°	140°
Expected Lifetime	100,000 Hrs	100,000 Hrs	100,000 Hrs	100,000 Hrs	100,000 Hrs
IP Rating (Front/Rear)	IP 30	IP 30	IP 30	IP 30	IP 30
Servicing	Rear	Rear	Rear	Rear	Rear
Scan Method	1/11 Scan	1/7 Scan	1/6 Scan	1/2 or 1/4 Scan	Static Scan

Typical Applications:

- Building Construction
- Shopping Mall
- Trade Show
- Rental Tour
- Fashion Store
- KTV
- Car Show
- Chain Store
- Theme Resort
- Window Display
- Hotel
- Company Reception